

F150 Series	Class 150	CF8M	TFM Seat
FIRE SAFE API 607-7			Size 10"-12"

**DS-F150-SS-F-G-G-V-N-HC**

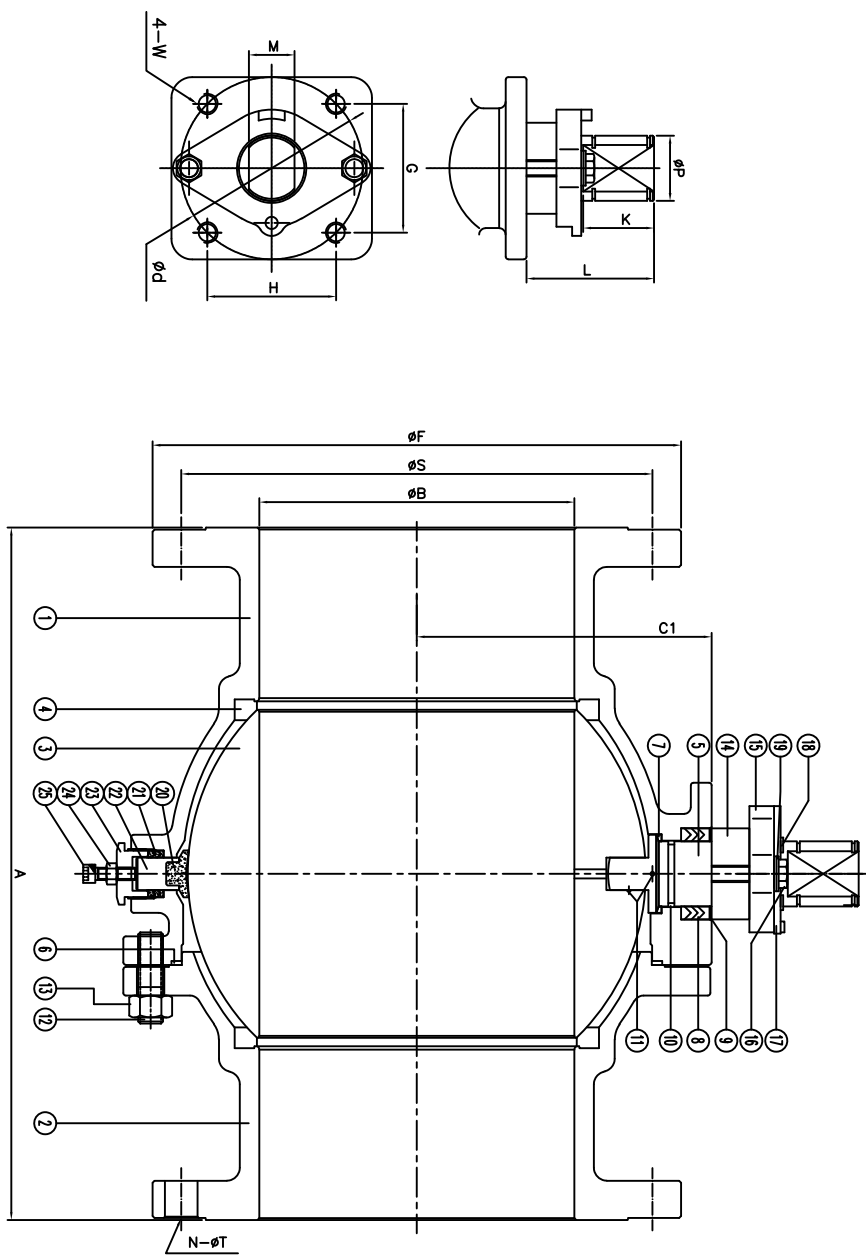

Size	A	B	C1	F	N	S	T	d	G	H	K	L	M	P	W	ISO
10"	21.0	9.84	9.88	16.0	12	14.25	1.00	5.51	3.897	3.897	2.12	3.86	1.378	1.97	5/8-11unc	F14
12"	24.0	11.8	11.5	19.0	12	17.0	1.00	5.51	3.897	3.897	2.12	3.86	1.378	1.97	5/8-11unc	F14

For certified drawing, consult factory

Drawn by:	Date:	Scale: NTS	Rev: 0	Drawing Title: Flange Ball Valve Class 150 10" - 12" Bare Stem
Checked by:	Date:	Unit: inch	Sheet: xxx	Drawing No.: DS-F150SSFGV-N-04-HC
Approved by:	Date:	Material: See Notes		

ANSI RATING CLASS 150	ASME B16.34
SEAT TEST @ 80-100 PSI	ASME B16.34
SHELL TEST @ 425 PSI	ASME B16.34
PRESSURE TEMPERATURE RATING	ASME B16.34
FACE TO FACE DIMENSION	ASME B16.10
END CONNECTION	ASME B16.5
JOINT STRENGTH	ASME B16.34
WALL THICKNESS	ASME B16.34
BASIC DESIGN	ASME B16.34

No.	Name	Material
1	Body	Stainless Steel
2	Cup	ASTM A351 CF8M
3	Ball	ASTM A351 CF8M
4	Seat	TFM
5	Stem	SS316
6	Gasket	316 SS316/Graphite
7	Thrust Washer	25%Carbon+TFM
8	Stem Packing	Graphite
9	Packing Protector	50%PTFE+SS316
10	O-Ring	Viton
11	Anti-Static	SS316
12	Body Stud	ASTM A193 B8
13	Body Nut	ASTM A194 Gr. 8
14	Packing Follower	SS304
15	Packing Gland	17-4Ph
16	Gland Bolt	SS304
17	Towel Stopper	SS304
18	Snap Ring	Polished Steel
19	Belleville Washer	SS301
20	Pin Seat	PPTFE
21	Pin Packing	Graphite
22	Support Pin	SS316
23	Support Nut	SS304
24	Set Nut	SS304
25	Tuning Screw	SS304

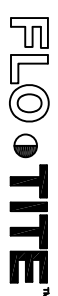

4815 W. 5th Street  
Lumberton, NC 28358  
Website: www.flo-tite.com  
Tel: 910-326-8904  
Fax: 910-326-9112  
E-mail: flo-tite@flo-tite.com

REVIEW ALL STANDARD SOFT PARTS FOR APPLICATION COMPATIBILITY