

Hi-TEK Double Offset Butterfly Valves



Double Offset Design

Size Range: 2" - 110"

ANSI Class 150/300

Wafer, Lug and Flanged

Forging and Casting Options

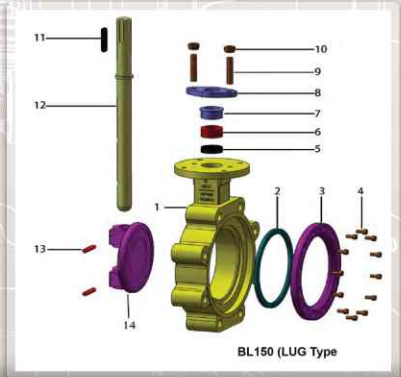

The Hi-Tek Series Specializes in a wide selection of special alloys

- Titanium
- Nickel
- Monel
- Zirconium
- Duplex
- Hastelloy
- Incoloy
- Inconel
- Super Duplex



Maxseal Inc
4815 West 5th Street
Lumberton, N.C. 28358

www.maxsealinc.com

Hi-TEK

Triple Offset Butterfly Valves

Triple Offset Design

Size Range: 2" - 110"

ANSI Class 150/300

Wafer, Lug and Flanged

Forging and Casting Options

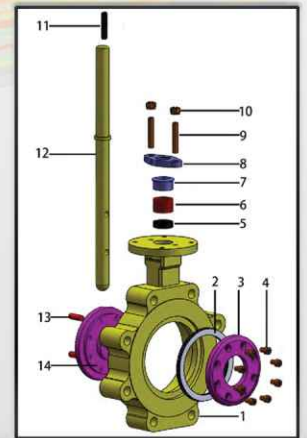

The Hi-Tek Series Specializes in a wide selection of special alloys

- Titanium
- Hastelloy
- Nickel
- Incoloy
- Monel
- Inconel
- Zirconium
- Super Duplex
- Duplex

Maxseal Inc
4815 West 5th Street
Lumberton, N.C. 28358

www.maxsealinc.com

